

CONSTRUCTION ISSUE

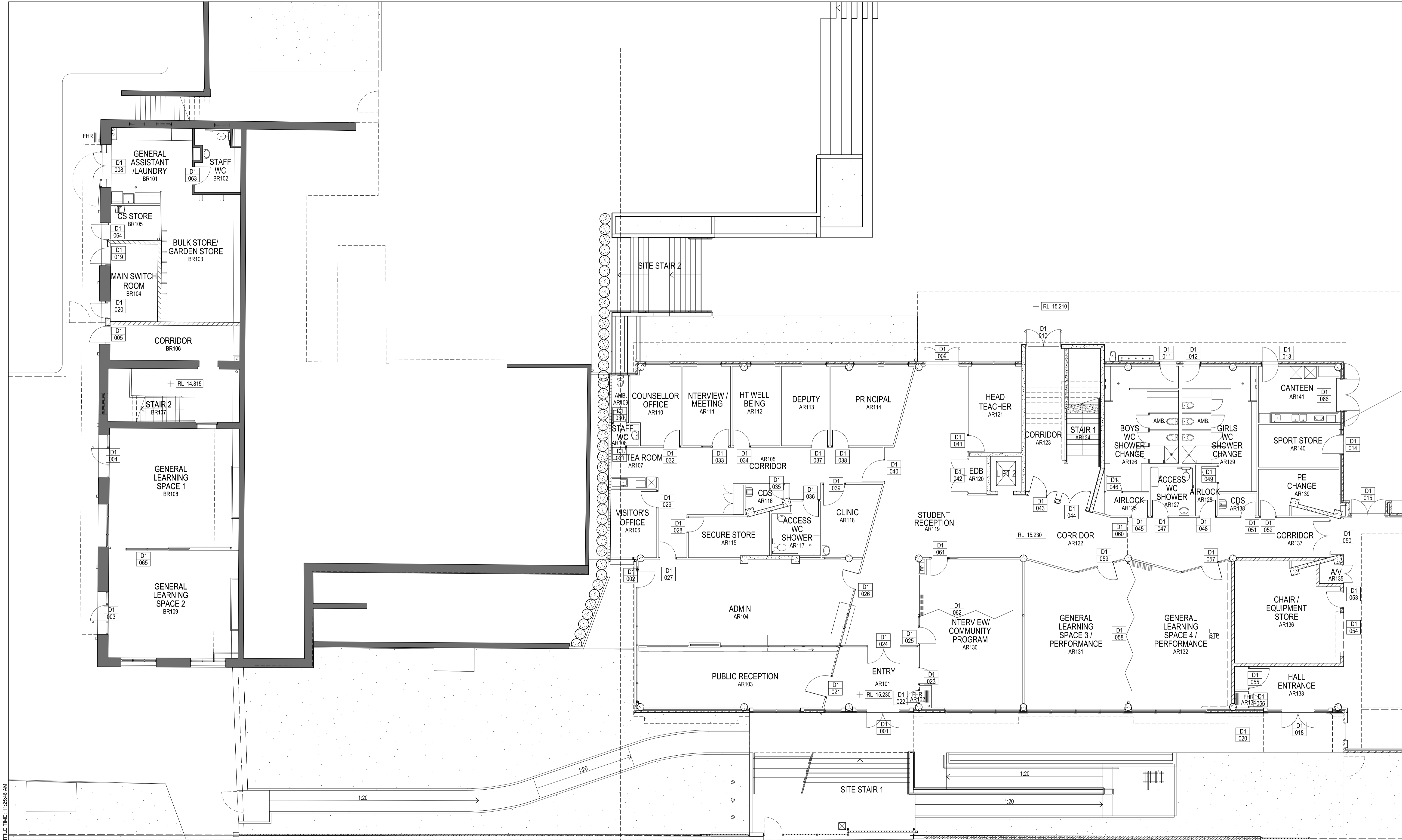

PLOT FILE DATE: 30/06/2018 PLOT FILE TIME: 11:25:46 AM

REV#	BY	DATE	DESCRIPTION
1	PPA	20.05.17	ISSUE FOR CONSTRUCTION
2	PPA	12.04.18	DRAWING TITLE REVISED - REISSUED FOR CONSTRUCTION
3	PPA	01.05.18	RELOCATED HYDRAULICS SERVICES IN FIRE RATED RISER - RE-FC
4	PPA	10.05.18	WALL TYPE CODE ADDED - REISSUED FOR CONSTRUCTION
5	PPA	21.05.18	COLUMNS UPDATED TO ALIGN WITH STRUCTURAL WINDOWS UPDATED
6	PPA	01.06.18	SANDSTONE DETAILS ADDED - REISSUED FOR CONSTRUCTION
7	PPA	05.07.18	DIMENSIONS ADDED - REISSUED FOR CONSTRUCTION

**NOTES:**  
 1. ROOM TO FIGURED DIMENSIONS, DO NOT SCALE FROM DRAWING. ANY DIMENSION DISCREPANCIES TO BE CLARIFIED WITH ARCHITECT.  
 2. CONTRACTOR TO VERIFY SITE CONDITIONS PRIOR TO CONSTRUCTION AND REPORT ANY DISCREPANCIES TO ARCHITECT.  
 3. REVISIONS TO BE MADE IN ACCORDANCE WITH THE TOTAL PACKAGE HOLDINGS BUT NOT LIMITED TO ANY AUTHORITY COMMENTS AND CONDITIONS. BSA SYSTEMS, DESIGN SURVEY, INTERPRETATION, FIXTURES & FINISHES SCHEDULE AND TENDER FORMS.

ALL ASPECTS OF CONSTRUCTION TO COMPLY WITH BCA AND ALL RELEVANT AUSTRALIAN STANDARDS.  
 DRAWING TO BE USED IN CONJUNCTION WITH THE TOTAL PACKAGE HOLDINGS BUT NOT LIMITED TO ANY AUTHORITY COMMENTS AND CONDITIONS. BSA SYSTEMS, DESIGN SURVEY, INTERPRETATION, FIXTURES & FINISHES SCHEDULE AND TENDER FORMS.



**STRUCTURAL CIVIL + HYDRAULIC**  
 WOOLACOTT'S CONSULTING ENGINEERS  
 T: 02 8241 9900 F: 02 8241 9999

**ELECTRICAL, COMMS, AV + ESD**  
 JMA CONSULTING  
 T: 02 9437 1000

**MECHANICAL**  
 ERBAS & ASSOCIATES  
 T: 02 9437 7052

**PLANNER**  
 ROBERTS DAY PLANNERS  
 T: 02 8232 9200 F: 0437 259 581

**LANDSCAPE**  
 LORNA HARRISON PTY LTD  
 T: 02 9555 1147 F: 02 9555 1146

**PROJECT MANAGER**  
 ROOT PROJECTS  
 T: 02 8272 9200

**HERITAGE**  
 PERUMAL MURPHY ALESSI  
 T: 02 9212 5524 F: 0417 449 242

**TRAFFIC CONSULTANT**  
 TTM CONSULTING PTY LTD  
 T: 02 9417 2003

**PERUMAL PEDAVOLI ARCHITECTS**  
 T: +61 2 9291 0000  
 WEB: www.pp-a.com.au  
 Non-Notarised Architect  
 Vince Pedavoli NSW reg No. 5045

**RELOCATION OF CLEVELAND STREET IEHS**  
 MITCHELL ROAD, ALEXANDRIA NSW

**FLOOR PLAN LEVEL 1 - PART A**

SCALE 1:100 @ A1

26 JULY 2018

DRAWING NUMBER: 3186 DISCIPLINE: ARC PHASE: CD SERIES NUMBER: 01\_011 REVISION: 6